

# Installation Instructions For Light Bar Fitting Accessory

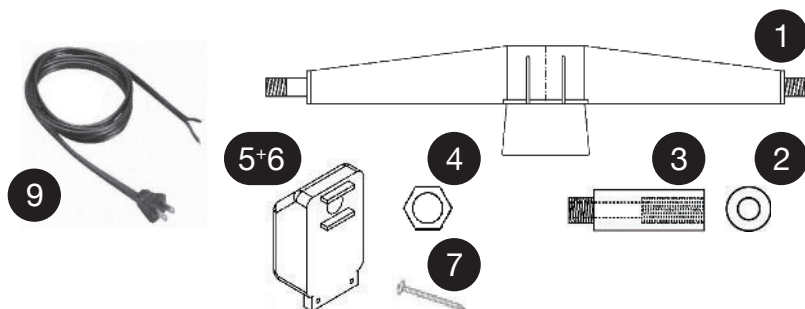

**SOLATUBE®**  
Innovation in Daylighting™



## Required Tools & Materials

10mm or 3/8 drill

Screwdriver

Pencil

Tape measure

## Parts List DS KIT ASSEMBLY\*

		Qty
1	Main Light Bar	1
2	Spacer	1
3	Extension Bar (only for 290 & 400 models)	2
4	Nut	2
5	Terminal / Junction Box	1
6	Terminal / Junction Box Cable Clamp	1
7	Cable Clamp Screw	2
8	Max 75W Warning Label	1
9	Power Lead and Plug Pre Assembled	1
10	Electrical Information Label	1

**WARNING:** Risk of fire and electrical shock. This product is to be installed only by a qualified person. Please read and understand the following before beginning installation

- This electric light kit is intended for use solely as a component of Solatube® daylight systems and should be used only in the manner intended by the manufacturer. If you have any questions, please contact the supplier.
- Installation work and electrical wiring must be carried out by qualified persons, and in accordance with all applicable codes and standards, including fire-rated construction.
- This electric light kit is intended for use only in residential applications.
- Before servicing or cleaning the unit, switch off power at the service panel and lock service panel to prevent power from being switched accidentally. When the service disconnection switch cannot be locked, securely fasten a prominent warning device, such as a tag, to the service panel.
- When cutting or drilling into a wall or ceiling, take care not to damage electrical wiring and other hidden utilities.

**Positioning the lamp holder assembly** Two 10mm diameter holes will need to be drilled into opposite sides of the bottom tube assembly. The position of these holes (distance L in Diagram A) can be determined once the bottom tube assembly has been installed in the ceiling and the angle adaptor positioned to correctly face the top tube assembly. Generally, the lamp holder will be positioned 170mm above the ceiling line although this may vary according to the length of lamp (light bulb) you have chosen and the angle of the adaptor.

The final lamp position should have a minimum clearance of 20mm from the diffuser. When you have determined the correct position of the holes, drill into the outside of the bottom tube assembly and remove any burrs or sharp edges.

**Installing the lamp holder assembly** Hold the lamp holder assembly at an angle inside the ceiling tube assembly. Insert the end with the wires through one of the drilled holes. The other end of the lamp holder assembly can then be inserted into the opposite hole (Diagram B).

**Note:** Item 3 extension bars are only needed for the 290/400 model and should be screwed to the ends of the light bar item 1 prior to this step.

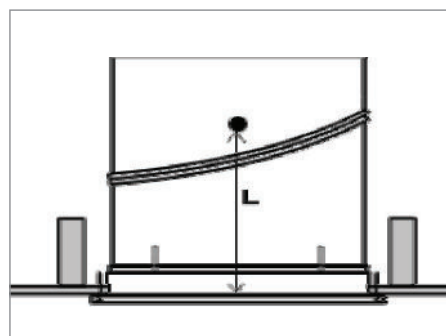

A

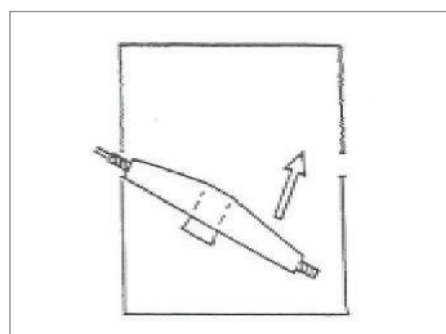

B

## Installation Instructions For Light Bar Fitting Accessory



**SOLATUBE®**  
Innovation in Daylighting™

**Securing and wiring the lamp holder assembly** Screw the two clamping nuts back on to the lamp holder threads. Connect the wires to the terminal block provided. The connector block can then be connected to existing lighting circuits.

**Electrical wiring should be undertaken only by qualified personnel.** The lamp configuration requires an Edison screw fitting, rated up to 75 Watts.

Place the **75W label** on the bottom middle of the skylight tube.

Place the **information label** on the outside of the skylight tube near the junction box.

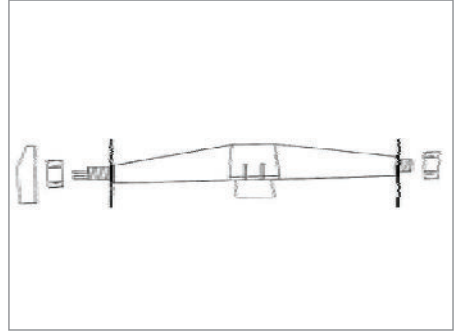

C

**NOTE: The spacer is used on all four Light Bar fittings.**

### **#290 and 400 Light Bars**

Fit spacer to long end first followed by extension bar.

### **#160 DS and HP 250**

Fit spacer to long end after light bar has been installed  
– followed by junction box.

### **#HI 250**

Fit spacer to long end before installing light bar.

**For the most current installation instructions, please visit [www.solatube.com.au](http://www.solatube.com.au)**

Solatube Australia | PO Box 6689 | Weatherill Park | NSW 2164 | +61 1800 131 619 | 13 16 19 | [www.solatube.com.au](http://www.solatube.com.au) | Part No. IN-LFK-A