

CAUTION: Raw edges of skylight components and cut edges of roofing iron are sharp. Care must be exercised during installation to avoid injury.

SAFETY PROCEDURES: Ensure there are no electrical wires, plumbing or other obstructions in the way when cutting out the penetration in both the ceiling and roof. If obstructions are present, contact the related tradesperson to make safe the area.

**NOTE: Please familiarise yourself with components prior to installation.
The installation procedure is exactly the same for all four flashings**

Step 1:

Take the roof flashing, flashing screws, metal foam tape, sealant and appropriate tools onto the roof. Centre the flashing over the hole (marked location) and mark the inside circumference of the flashing onto surface of roof sheeting (Photo 1).



Step 2:

Mark the two internal corners onto surface of roof sheeting (Photo 2).

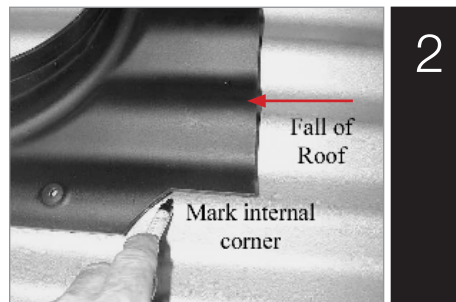

Step 3:

Using the front edge of the flashing as a straight edge, draw a line across roof sheeting joining the 2 marked dots internal corner dots (Photo 3).



Step 4:

Draw a line from each end of the top cutting line to the cord of the circle (Photo 4).

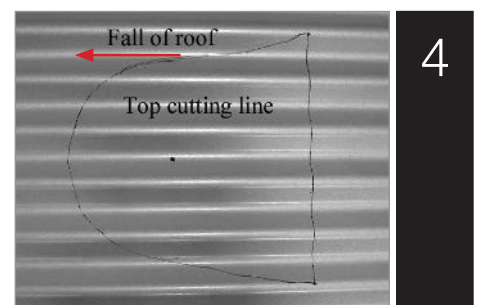

Using tin snips, hacking knife, electric shears cut out along the marked lines.

NOTE: Do not use a angle grinder to cut out section.

Step 5:

Remove backing paper from foam seal tape and apply 2 strips to the top surface of tongue section of flashing (Photo 5).



Step 6:

Remove backing paper from foam seal tape and apply 1 strip to the front bottom surface of the flashing (Photo 6).

NOTE: The foam seal tape must be positioned between fixing holes and front edge, placing tape closer to the fixing holes.

NOTE: Finish each end at the bottom of the outside valley. "Do not take to edge of the flashing."

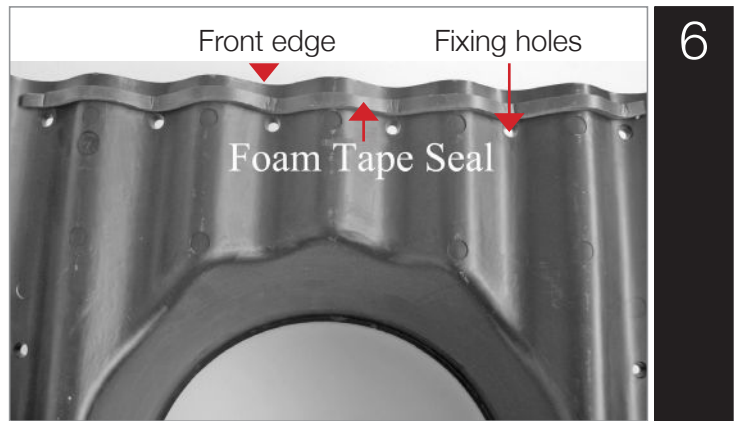

Step 7:

Remove backing paper from cut-out foam seals and apply to the bottom surface of plastic caps (Photo 7).

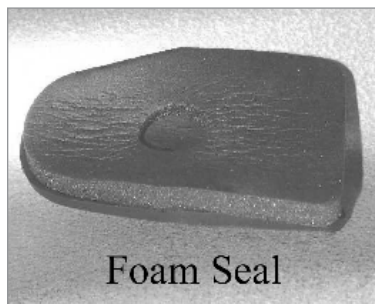

Step 8:

Insert the back section of the flashing into the cut out section of the roof, pushing the flashing back until the 2 internal corners push up into top 2 corners of cut out (Photo 8).



Step 9:

Flashing in position and ready for fixing (Photo 9).



Step 10:

Before securing front section of flashing, slightly lift front of flashing and apply a bead of sealant between flashing and roof sheeting (Photo 10).

NOTE: Must use a suitable sealant such as Dow Corning 780, Selleys Wet Seal or Selleys All Clear.

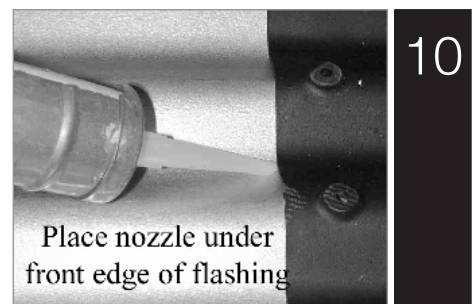

Step 11:

Starting at the front of the flashing and working from the middle fixing hole and out to both sides and then up each side, proceed to secure flashing with roof Tek-Screws (Photo 11).

NOTE: Be careful not to overtighten screws, as they may strip from metal sheeting.



Step 12:

Before securing back of flashing with Tek-Screws, place nozzle of sealant under edge of roof sheeting and apply a bead of sealant between roof sheeting and flashing, where flashing tucks under roof sheeting (Photo 12).

TIP: When installing the 400 size flashing, it is advisable to fit support timber trimmer under the roof sheeting just up behind the back section of the skylight flashing when there is no support via a batten or purlin.

Refer to dotted outline in Photo 12.

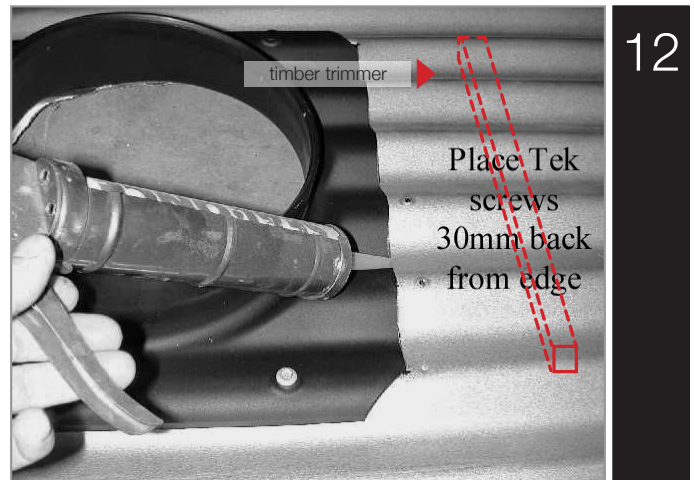

Step 13:

Position seal fixing caps over top 2 corners and secure with Tek-screws (Photo 13).

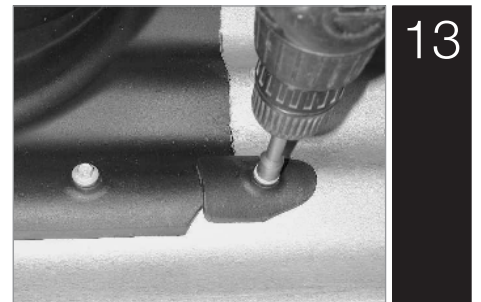

Step 14:

ANTI-CAPILLARY CUT

If the skylight flashing is installed on the overlap of roof sheets, then an anti-capillary cut (frog mouth) must be made 200mm to 300mm up from flashing cut out and on the outer overlap rib.

Before installing fixing screws at back of flashing, apply a bead of sealant in the underlap below anti-capillary cut as marked in Photo 14.

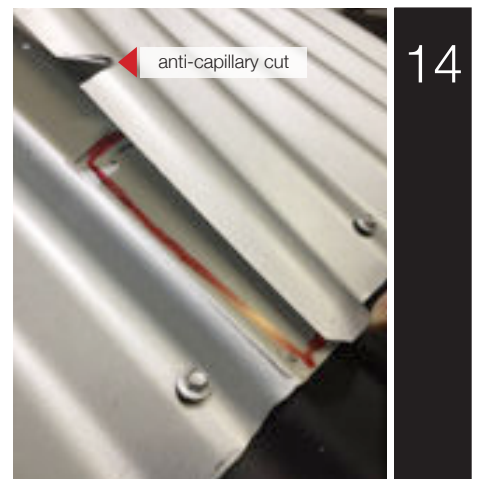

NOTE: This installation instructions must be followed as specified for an effective installation result. Any deviation from this installation instructions will void the warranty.