

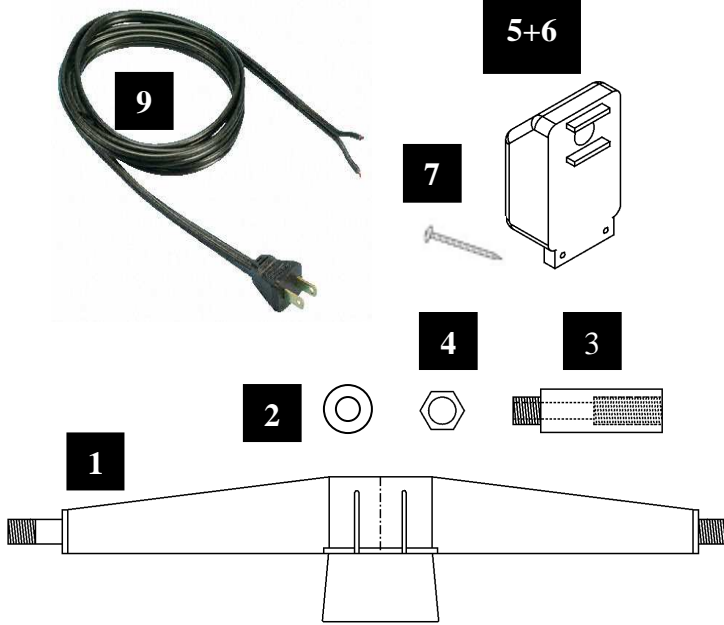

Solatube® Brighten Up® Series

Solatube® 160DS / 290DS Daylighting System

Installation Instructions. Light Fitting Accessory.



Parts List DS KIT ASSEMBLY *	Quantity
1 Main Light Bar	1
2 Spacer	1
3 Extension Bar (only required for 290 model)	2
4 Nut	2
5 Terminal / Junction Box	1
6 Terminal / Junction Box Cable Clamp	1
7 Cable Clamp Screw	2
8 Max 75W Warning Label	1
9 Power Lead and Plug Pre Assembled	1
10	

Required Tools & Materials:

- 10mm or 3/8 drill
- Screwdriver
- Pencil
- Tape measure

WARNING: Risk of fire and electrical shock. This product is to be installed only by a qualified person.

Please read and understand the following before beginning installation:

- This electric light kit is intended for use solely as a component of Solatube® daylight systems and should be used only in the manner intended by the manufacturer. If you have any questions, please contact the supplier.
- Installation work and electrical wiring must be carried out by qualified persons, and in accordance with all applicable codes and standards, including fire-rated construction.
- This electric light kit is intended for use only in residential applications.
- Do not install this electric light kit or place a switch where it can be reached from a bathtub or shower.
- Before servicing or cleaning the unit, switch off power at the service panel and lock service panel to prevent power from being switched accidentally. When the service disconnection switch cannot be locked, securely fasten a prominent warning device, such as a tag, to the service panel.
- When cutting or drilling into a wall or ceiling, take care not to damage electrical wiring and other hidden utilities.

Positioning the lamp holder assembly Two 10mm diameter holes will need to be drilled into opposite sides of the bottom tube assembly. The position of these holes (distance **L** in **Diagram A**) can be determined once the bottom tube assembly has been installed in the ceiling and the angle adaptor positioned to correctly face the top tube assembly. Generally, the lamp holder will be positioned 170mm above the ceiling line although this may vary according to the length of lamp (light bulb) you have chosen and the angle of the adaptor. The final lamp position should have a minimum clearance of 20mm from the diffuser. When you have determined the correct position of the holes, drill into the outside of the bottom tube assembly and remove any burrs or sharp edges.

Diagram A

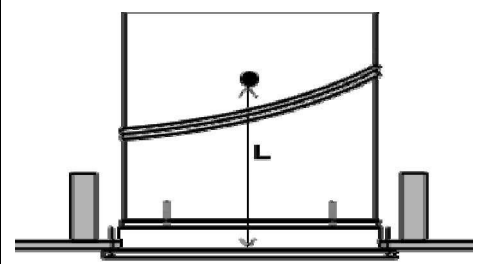

Installing the lamp holder assembly Remove the two clamping nuts and hold the lamp holder assembly at an angle inside the ceiling tube assembly. Insert the end with the wires through one of the drilled holes. The other end of the lamp holder assembly can then be inserted into the opposite hole (**Diagram B**). **Note: Item 3 extension bars are only needed for the 290 model and should be screwed to the ends of the light bar item 1 prior to this step.**

Diagram B

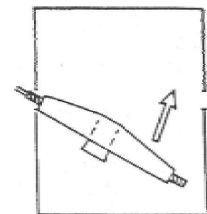

Securing and wiring the lamp holder assembly Screw the two clamping nuts back on to the lamp holder threads, ensuring the two wires continue to protrude through the centre channel of the bar and are not compressed by the clamping nuts. Connect the wires to the terminal block provided. The connector block can then be connected to existing lighting circuits. **Electrical wiring should be undertaken only by qualified personnel.** The lamp configuration requires an Edison screw fitting, rated up to 75 Watts. We suggest low energy lamps be used if possible as they are more energy efficient.

Diagram C

